



THE
A-TEAM

**RE/MAX
FIRST**

126 BELVEDERE Crescent, Calgary t2a7g2

MLS® #: **A2207039**

Area: **Belvedere**

Listing Date: **03/30/25**

List Price: **\$545,000**

Status: **Active**

County: **Calgary**

Change: **None**

Association: **Fort McMurray**

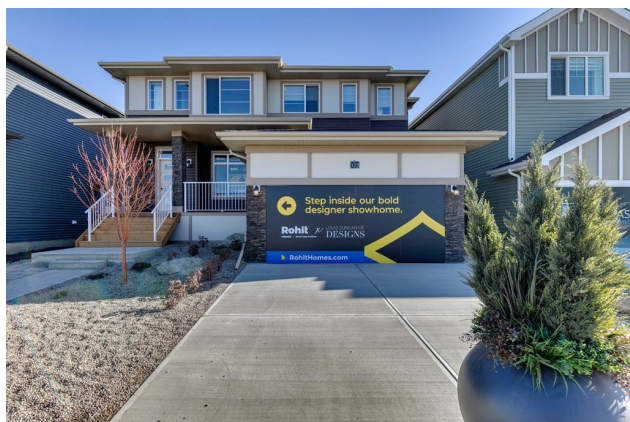

General Information

Prop Type:

Residential

Sub Type:

Semi Detached (Half

Duplex)

Finished Floor Area

City/Town:

Calgary

Abv Sqft:

1,504

Year Built:

2025

Low Sqft:

Ttl Sqft:

1,504

Lot Information

Lot Sz Ar:

2,464 sqft

Lot Shape:

DOM

25

Layout

Beds:

3 (3)

Baths:

2.5 (2 1)

Style:

2 Storey,Attached-Side by Side

Parking

Ttl Park:

2

Garage Sz:

Access:

Lot Feat:

Park Feat:

**Back Yard,Corner Lot,Landscaped,Rectangular Lot
Alley Access,Parking Pad**

Utilities and Features

Roof: **Asphalt Shingle**

Heating: **Forced Air**

Sewer:

Ext Feat: **Other,Private Entrance**

Construction:

Wood Frame

Flooring:

Carpet,Ceramic Tile,Laminate

Water Source:

Fnd/Bsmt:

Poured Concrete

Kitchen Appl:

Dishwasher,Electric Stove,Microwave Hood Fan,Refrigerator,Washer/Dryer

Int Feat:

High Ceilings,Kitchen Island,Open Floorplan,Quartz Counters,Separate Entrance

Utilities:

Room Information

Room	Level	Dimensions
Living Room	Main	13`0" x 16`1"
Kitchen	Main	8`10" x 9`10"
Bedroom	Upper	13`0" x 8`5"
Bedroom - Primary	Upper	12`9" x 11`11"
4pc Bathroom	Upper	0`0" x 0`0"

Room	Level	Dimensions
Dining Room	Main	16`4" x 8`6"
2pc Bathroom	Main	0`0" x 0`0"
Bedroom	Upper	7`9" x 10`4"
4pc Ensuite bath	Upper	0`0" x 0`0"
Bonus Room	Upper	8`1" x 8`0"

Legal/Tax/Financial

Title:
Fee Simple
Legal Desc:

Zoning:
r-g

tbd

Remarks

Pub Rmks:

***Visit show home at 318 sora way SE Calgary mon-thurs 4-7pm, sat/sunday 2-5pm. Self guided tours available outside those times! HALF DUPLEX "TALO" Floorplan, with 3 bed/2.5 bath + Bonus by 'Rohit Homes' - an award winning home builder for over 35 years. FEATURING: | SEPARATE ENTRANCE | LARGE WINDOWS | CONCRETE PARKING PAD | BRAND NEW | All Perfectly located In SE Calgary's 'Sora in Hotchkiss', close to a park, featuring a pond, paths, easy access to major highways and more. Step inside to an expansive open floor plan that seamlessly connects living/dining and kitchen. KITCHEN FEATURES: SS appliances, quartz counters, large island (with place for bar stools), cabinets to ceiling (42' tall), boutique lighting - a perfect place to gather and create masterful meals. Off the kitchen is the dining, mid room and half bath. The TALO plan offers windows across the back and front, and with the high ceilings as well as open floor plan, it leaves the home feeling bright and inviting. Upstairs, find 3 good size bedrooms, bonus room, laundry, 2 full baths. The primary retreat includes a walk in closet, and spa like retreat full en-suite. Ensuite features: Single vanity, window, bath/shower combo with rain head and wand, quartz counters and beautiful tile work. The lot features alley access in the back to a concrete parking pad (double).. This home is packed with features that make it a great option to consider for your next home purchase. Located just outside the ring-road, east of Stoney Trail, offering quick access to highways and other amenities on the southeast side of Calgary. All pictures and 3D tours are of the 'TALO' floorpan that is completed, your unit may have different (colors/finishings/spec upgrades/design interior/elevation) depending on Lot - confirm with builder. Get moving on this brand new place - before it's gone! *Visit show home at 318 sora way SE Calgary mon-thurs 4-7pm, sat/sunday 2-5pm. Self guided tours available outside those times!**

Inclusions:
Property Listed By:

n/a
RE/MAX Real Estate (Mountain View)

TO VIEW THIS PROPERTY WITH AN A-TEAM BUYER'S AGENT PLEASE CONTACT (587) 700-7123







The TALO Bold Designer Townhome

3 Bed
2.5 Bath
1506 sq ft

Main Floor Features

104 sq ft 8 ft ceiling

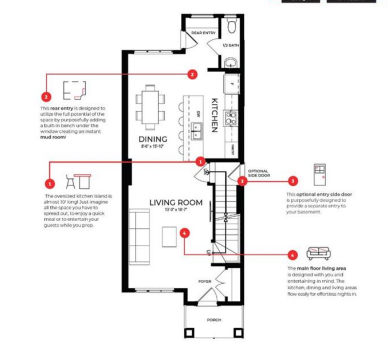

The TALO Bold Designer Townhome

3 Bed
2.5 Bath
1506 sq ft

Upper Floor Features

104 sq ft

